

M11 southbound between junctions 11 and 12: bridge joint repair works

Kier will be carrying out bridge joint repair works at the above location, on behalf of Highways England.

We plan to complete this work over **five nights**, from **Monday 28 January**, with working hours of **8pm to 6am**, weekdays only, weather permitting. A full closure of the M11 southbound between junctions 11, Westfield Interchange and junction 12, Haggis Farm Interchange, to repair bridges over the River Granta and Bourn Brook. A decision has been made to undertake maintenance work at both these locations to minimise future disruption.

A map showing the road closure and diversion route can be found below.

Diversion route

A clearly signed diversion route will be in place via the A603, A1198, A505 and A10. The diversion route is shown in the map below.

Diversion Map:

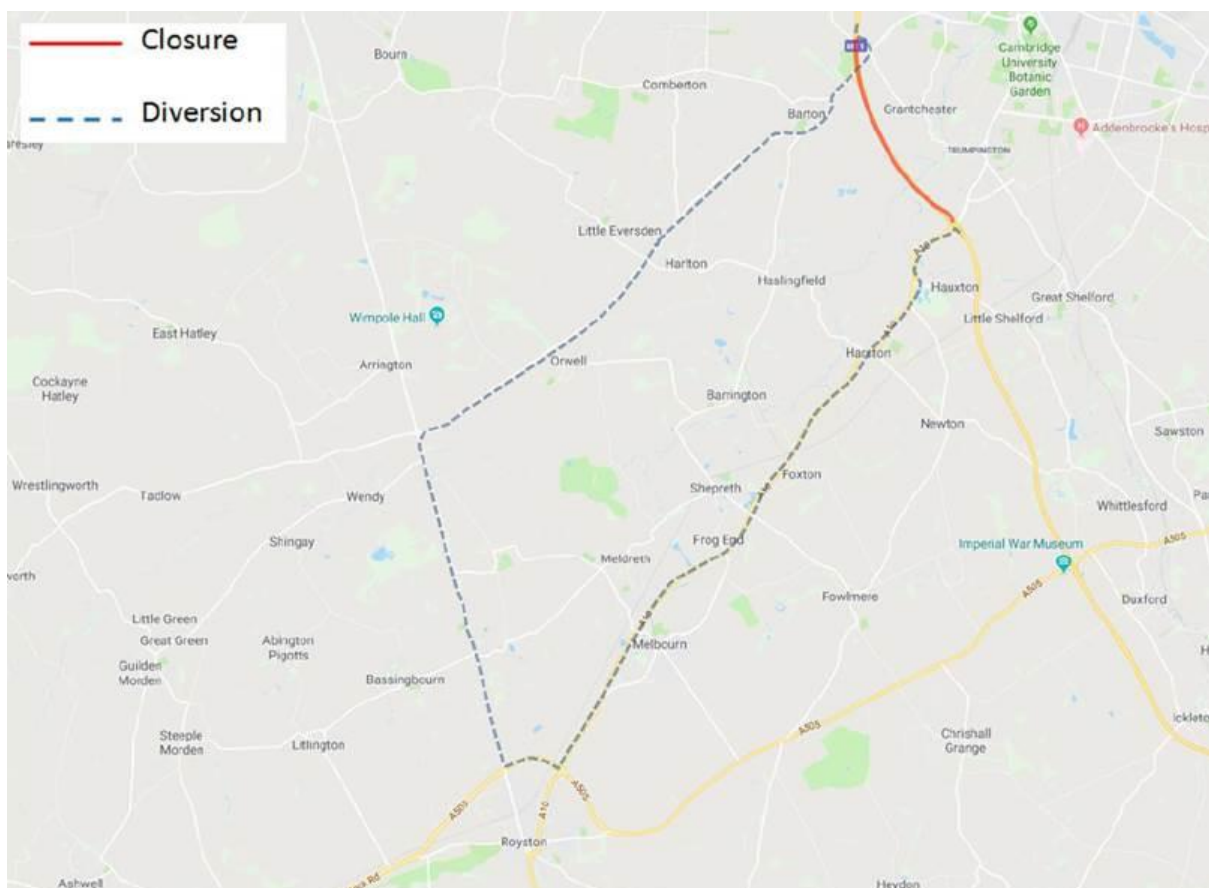

We apologise for the local inconvenience these works may cause and thank you for your patience whilst we carry out strategic maintenance to the road network. We would be grateful if you would share information locally about the works.

